

Vertical Form-Fill-Seal machine

This model opens the new generation of TAM flag ship VFFS!



Vertical Form-Fill-Seal machine

TWFX

Structural innovation makes change for usefulness



Double servo ensures sealing



Various kinds of film can be handled by control of 2 servomotors which, can set the value range of sealing pressure is doubled (Compare to our former model). Contamination detection in high precision is achieved by 'Intelligent seal'.

Improved workability



Wide-opening cover allows better workability for changing size-parts, cleaning and maintenance. Inside visibility is ensured by transparent cover.

Easy film setting



Time for changing film roll or splicing has been saved with the renewed structure. An assisting unit reduces workload for setting film roll.

Machine Specification

Bag types	Flat bag, Gusset bag, Square-bottom with gusset, Chain bag with header	
Bag size range	Width	50 – 200mm
	Length	50 – 300mm
Bag material	Various laminated film	
Packaging speed	Max 120 bpm	
Power supply	3-phase 200V 50/60 Hz 9.6kVA	
Power consumption	4.5 kW	
Air consumption	300 L(Normal)/ min * at speed 100bpm	
Machine dimension	W 979 mm x D 1751 mm x H 1420 mm	
Machine weight	800 kg	
Option	Thermal printer, Print detection device, Gas filling, Static Eliminator, Automatic splicer, Gusset device, Punch hole device, Chain bag with header etc.	

The above specification varies depend on material, products bag type etc.

Packaging Flow

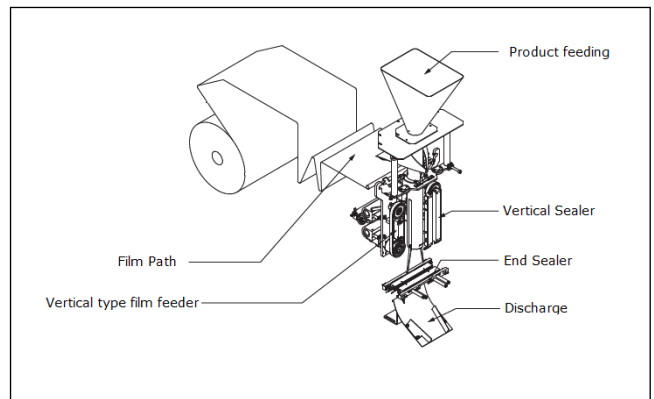

Machine Dimension (mm)

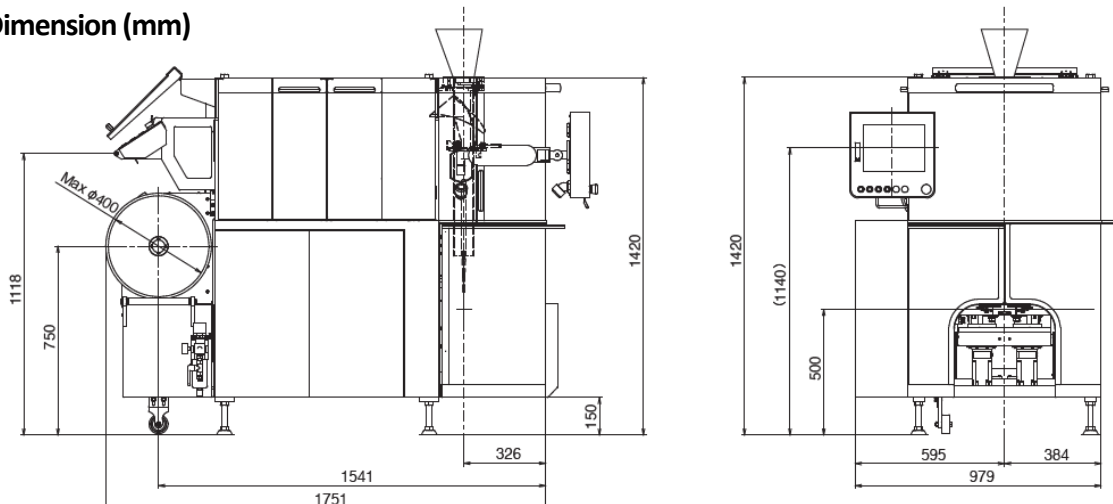

Tokyo Automatic Machinery Works, Ltd.

TOJIKI BLDG., 3-10-7 Iwamotocho, Chiyoda-Ku, Tokyo 101-0032 Japan
 TEL: 81-3-3866-4824 FAX: 81-3-3866-7150
 URL: <http://www.tam-tokyo.co.jp/>
 E-mail: tam-overseas@tam-tokyo.co.jp