

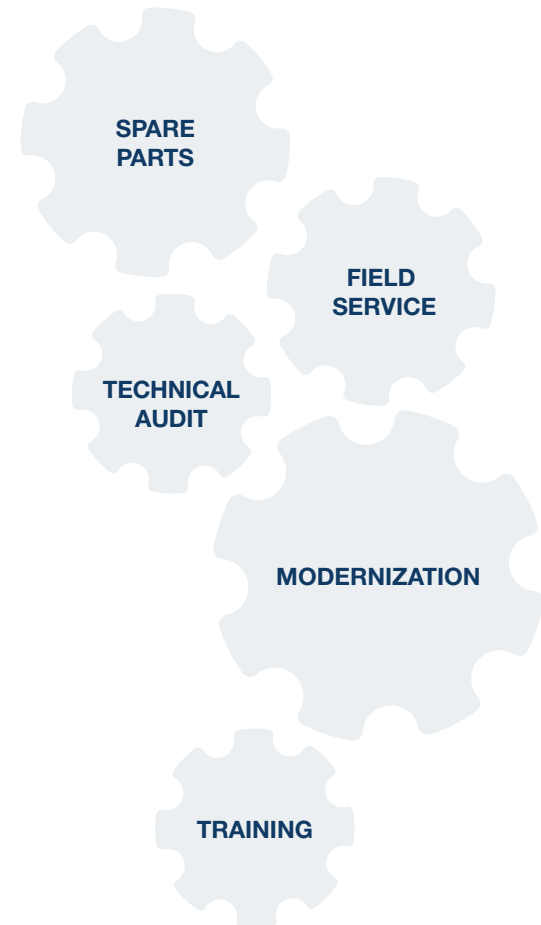

SAFE-PROOF YOUR PRODUCTION

Automating your line has never been easier with the scalable solutions from Sapal. By using modular units they can be easily adapted to meet future needs, including greater production volumes and higher speeds. Combined with an extensive range of after sales services, we are there to support you today and tomorrow.

Our comprehensive portfolio of services tailored to your specific needs includes Modernization, Spare Parts, Field Service, Technical Audit and Training for your employees. Everything has been designed for a single purpose: to assist you in achieving maximum output and minimum downtime for your Sapal packaging machines. Additionally, we can provide a refurbishment service for your used machines. This means we can purchase, refurbish and sell your machines, providing an economic alternative for your investment.



SAPAL SA
Av. du Tir-Fédéral 44 - 1024 Ecublens - SWITZERLAND - Phone +41 (0)21 633 53 00 - Fax +41 (0)21 633 52 11 - info@sapal.ch - www.sapal.ch

PACKAGING SOLUTIONS CHOCOLATE & SWEETS

Choose a reliable partner that shaped the market for more than 110 years.





CHOOSE THE RIGHT PARTNER

Focus on long-term partnership that delivers results today and tomorrow.

Keeping in mind how challenging it is to differentiate your product on supermarket shelves, we create unique solutions that help you stand out at point of sale. Offering a wide range of pack styles, we can recommend a solution that will both appeal to your customers and help you maintain effective production.

BENEFITS

- Brand differentiation with a premium pack style
- Short delivery time of spare parts
- Worldwide sales network and extensive after-sales support
- Whole range of high-speed machines with long lifecycle
- Optimized changeover time
- Fast return on investment

SELECT YOUR PERFECT SOLUTION

DSD 0600 H

Chocolate / Hermetic Premium Die-fold Wrapping Machine

World premiere, the DSD 0600 H is a hermetic wrapping machine providing you with attractive airtight packaging and full protection against contamination from dust, migrating aromas and insect penetration. The patented hermetic sealing technology extends the shelf life of products up to 25 grams. Additionally, you optimize material and energy usage as the machine is using a single layer of OPP.

This combination of classicism and modernity gives chocolate its traditional image, while increasing its protection.

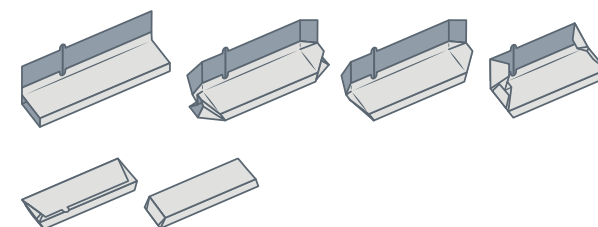

- Extended shelf-life
- Taste preservation
- Lower Life Cycle Cost (TCO)
- Reduced secondary packaging
- Excellent visibility of all the wrapping process
- Patented Sapal hermetic wrapping solution
- Both right and left hand version available
- Full sealing on three sides, longitudinal and side folds

DSD 0600

Chocolate / Multifformat Wrapping Machine

Enhance your production flexibility with one machine producing the most popular chocolate pack styles, including box fold, brush fold and double twist. Regardless of the shape and size of the packaging, the folds are perfectly symmetrical and boost brand image on the shelf. Offering high-speed production of up to 600 wraps per minute, the machine allows different types of material, including paper, aluminum, cellophane and OPP. Available in mirror configuration for easier operation.

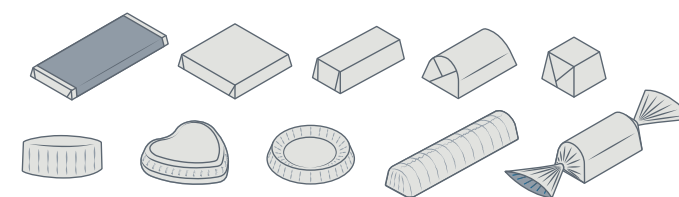

- Multifformat wrapping machine
- Perfect symmetry of the folds
- Reduced consumption of wrapping material
- Excellent visibility of all the wrapping process
- Clear overall vision
- Both right and left hand version available

DSD 0300

Multifformat Chocolate / Wrapping Machine

Multifformat wrapping machine for delicate flat base or spherical chocolates, such as ball or eggs to improve your product quality by using a very gentle product handling.

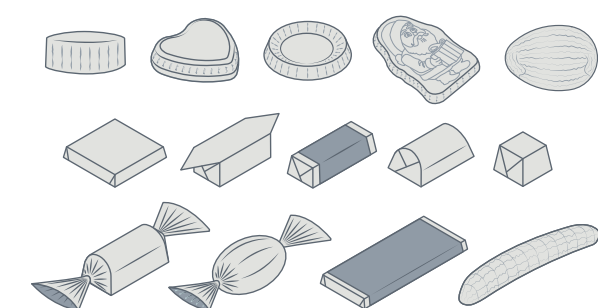

- Multifformat wrapping machine
- Flexibility
- Low total operating costs
- Clear overall vision
- Large choice of options
- High quality of tight wrap
- Excellent visibility of all the wrapping process
- Ergonomic

DPN7

Chocolate / Foil Wrapper

The DPN7 is a high-speed single lane wrapping machine for small products, able to wrap up to 525 chocolates per minute.

It's a one-foil wrapper especially designed for moulded, enrobed or special confectionery products with a flat base.

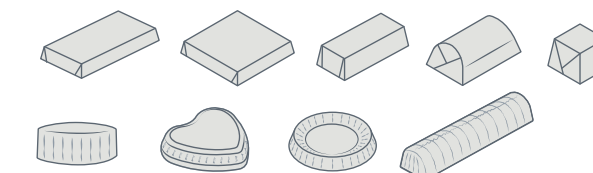

- Robust design
- High quality of tight wrap
- Multi-format machine according to market requirement
- Large choice of options (laser, hotmelt, ...)
- Accept high tolerances on product
- Swift and easy size changeover
- Excellent accessibility

DGD 0350 / 0700 DGD Overwrapper

Chewing Gum / Sweets / Wrapping Machine

The DGD 0350 and the DGD 0700 are automatic, adjustable high-speed wrappers for chewing gum pellets and pressed sweets. DGD Overwrapper adds a 2nd envelope and tear tape, extending shelf life and freshness.

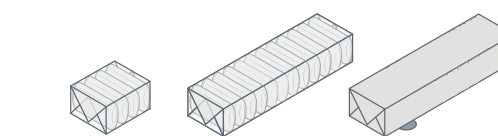

- High-speed machine
- Automatic lubrication
- Automatic splicer
- Folding station
- Retractable heat sealing jaws
- Designed for dust environment

SWISSPAC 5

Wafers / Wrapping Machine

The Swisspac 5 is a monosize high-speed wrapping machine which has specially been designed to wrap Austrian style wafers.

The Swisspac 5 is the only machine available on the market which can produce up to 250 packs per minute. The Swisspac 5 has an automatic and in-line product infeed.

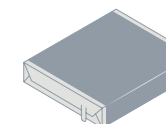

- Robust design
- High quality of tight wrap
- Protection from dusty atmosphere
- Low maintenance
- Gentle handling